

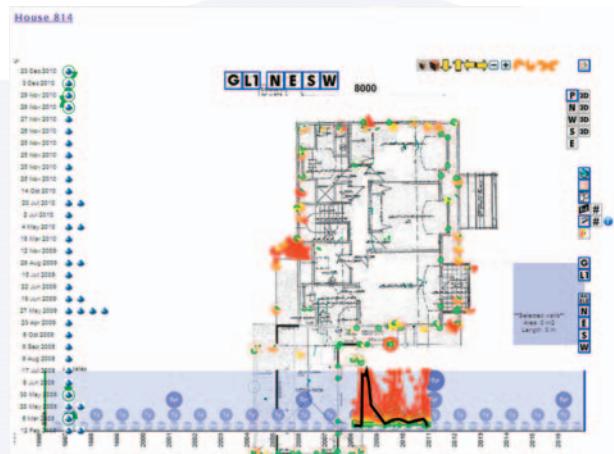

BNet is a unified building portal for all building stakeholders to easily access and manage performance and other building data to aide risk management, analysis and ensuring data longevity.

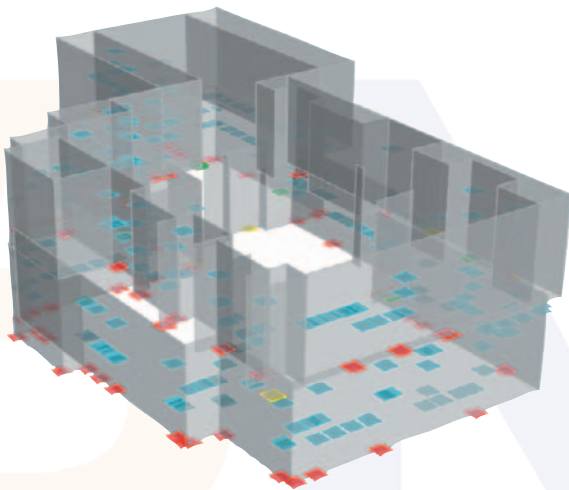

BNet is a world's first in-depth online building weathertightness performance management and analysis system, allowing users to simply and easily view, analyse and manage how their buildings are performing.

Overview

Date	Source	# MC analyse	# TS analyse	# Scan analyse	# VCR analyse	# Boron(S) analyse
2009-06-16 Jun	MDC	108	105	51	107	8
2009-06-24 Jun	MDC	58				
2009-07-24 Jul	MDC	85	27	10	27	
2009-08-16 Aug	Person 2259	73				
2009-09-17 Sep	Person 2259	73				
2009-10-06 Oct	MDC	73				
2009-11-26 Nov	Person 2259	73				
2010-02-09 Feb	MDC	72				
2010-06-10 Jun	MDC	73				
2010-07-02 Jul	MDC	9		2	4	
2010-07-09 Jul	MDC	7				
2010-10-15 Oct	MDC	73				
2010-10-29 Oct	MDC	14				4
2010-11-05 Nov	MDC				10	9

Building Evidence Table

For VCR columns: * = initial verified, (L) = lab verified

Probe #	Timber VCR		Timber Strength		Scan		Moisture Content (% MC)	
	Inner	Outer	Inner	Outer	Inner	Inner	Outer	Outer
31	C*	C*	6	5	17.0	15.5	1	18.5
32	C*	C*	5	1	17.4	18.5	1	17.0
33	C*	C*	6	1	20.2	21.0	1	16.2
34	C*	C*	6	6	19.2	18.8	1	20.5
35	C*	C*	6	6	20.3	21.0	0	
36	C*	C*	7	5	19.3	19.5	1	18.0
37	C*	C*	7	8	19.3	20.8	1	20.8
38	C*	C*	5	6	19.8	17.8	1	17.6
39	C*	C*	5	6	20.8	19.8	1	18.1
40	C*	C*	5	6	20.8	24.1	1	24.3
41	C*	C*	5	1	18.6	18.6	1	18.6
42	C*	C*	5	1	18.6	18.6	1	18.6
43	C*	C*	5	1	18.6	18.6	1	18.6
44	C*	C*	5	6	16.9	14.3	1	12.2
45	C*	C*	5	6	19.9	11.9	1	12.7
46	B*	B*	5	1	20.4	11.7	1	13.8
47	C*	B*	6	1	19.8	11.6	1	15.3
48	B*	C*	4	1	19.2	11.7	1	14.5
49	B*	B*	4	1	20.4	12.2	1	18.0
50	B*	B*	4	5	19.3	9.4	1	13.2
51	B*	B*	4	3	21.2	13.2	1	16.7
52	B*	B*	5	5	19.7	15.7	1	16.7
53	C*	C*	5	5	19.0	15.6	1	19.0
54	C*	B*	6	5	20.8	18.2	1	15.8
55	B*	B*	5	5	19.5	13.1	1	15.6
56	B*	B*	5	6	22.0	12.1	1	13.1
57	B*	B*	5	5	15.7	14.6	1	20.8
58	C*	C*	5	1	16.0	14.5	1	18.9
59	C*	C*	5	1	18.8	17.3	1	18.1
60	C*	C*	7	1	18.6	19.8	1	14.6

BNet is a secure online site with password protected web portal access to information allowing both convenient access and secure protection.



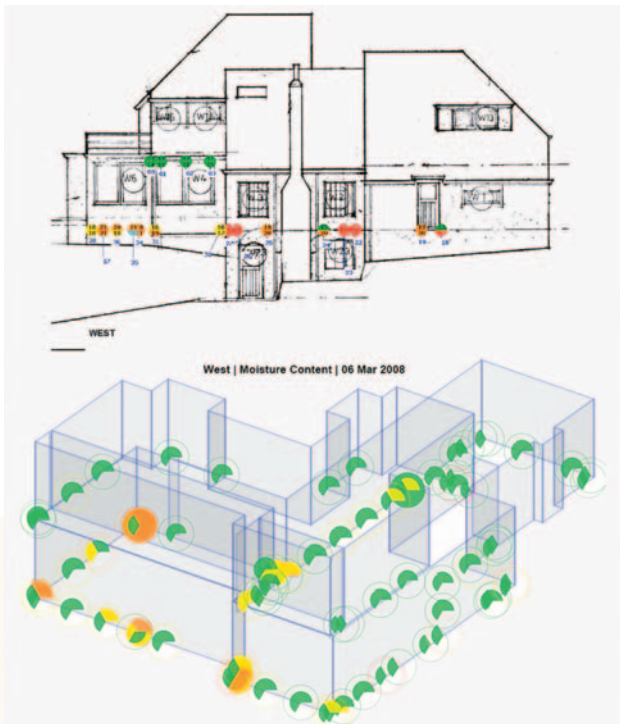

3D MODELING – Buildings are built in 3D construct – allowing seamless information integration. Accurately placed spacial information that is colour-coded allows for ease of interpretation and pattern analysis.

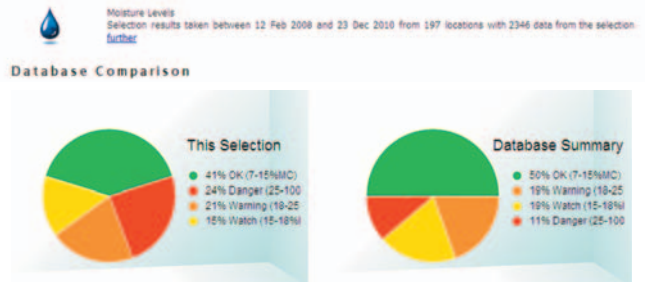

COMPARATIVE ANALYSIS – Building condition and performance results are compared to database averages and scores to determine overall rankings.

Search
6 matches found

Name	Date	Performance	#
House 2324	---	---	(3)
House 144	2007-Mar	---	(97)
House 1573	2011-Jan	---	(88)
House 1106	2009-Jan	---	(27)
House 814	2010-Dec	---	(95)
House 2256	2011-Jan	---	(77)

PROPERTY TRACKING – Automatically updated, Multi-Stakeholder access – When a building's performance results are updated, the results are immediately accessible by all with authority to view. Simple to understand – A centralised colour-coding scheme allows for easy interpretation.



SIMPLE TO USE – BNet requires no downloads, installs, and no programs to use. It runs from your internet browser. BNet is built on web friendly frameworks and allows its users access to their information over the internet.

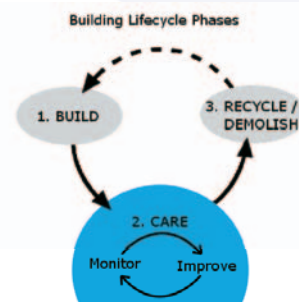

LIFECYCLE INFORMATION STORAGE – Net data follows the complete lifecycle of the building. BNet enables you to keep track of a building's performance even if you haven't seen it in years. It builds your portfolio of properties and lets you check them at the click of a button. Successive owners continue to feed performance information into BNet and giving you continual feedback for free.